

15 CHANNEL REMOTE LUNA GLIDE INSTRUCTIONS

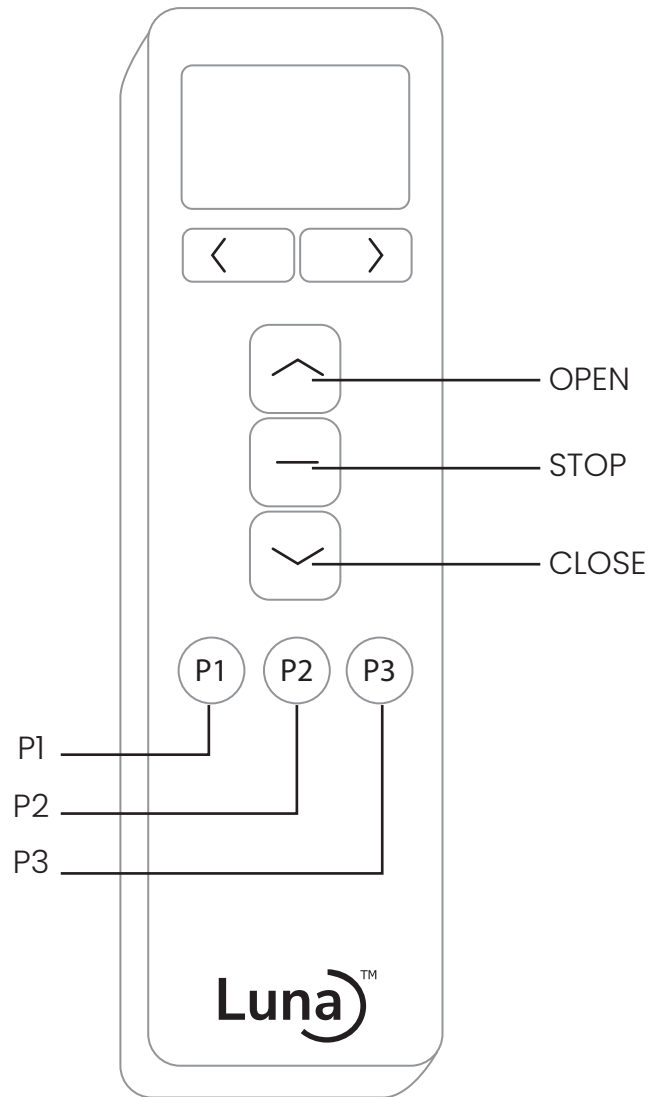

LED states

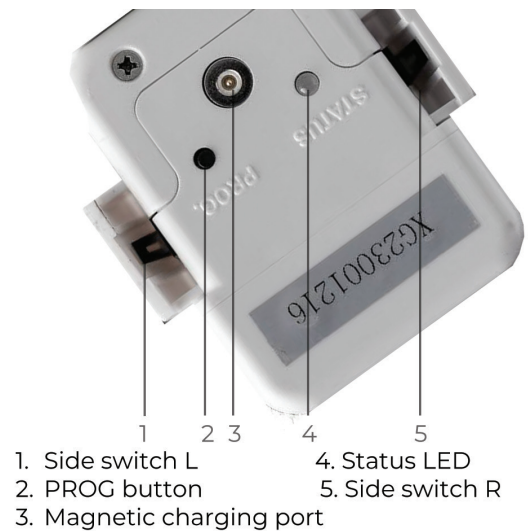

| | |
|---------------------|------------------------------|
| Solid green | Motor is in RF pairing mode |
| Solid amber | Motor is currently charging |
| Green blink x2 | Command received |
| Green blink x3 | Wake up from deep sleep mode |
| Amber blink x3 | Enter deep sleep mode |
| Red blink in motion | Battery low / limits not set |
| Red blink x2 | An error has occurred |



15 CHANNEL REMOTE LUNA GLIDE INSTRUCTIONS

Using the Onboard Controls

Pairing a channel to remote

1. Press and hold the **PROG** button until the status **LED** turns solid green.
2. Select the desired channel on the remote handset.
3. Press and hold the  and  buttons on the remote.
4. After 3-5 seconds, the motor will jog to indicate successful pairing. The status **LED** will also flash green twice, then turn off.
5. Pairing is now complete.

Limit setting

1. Manually position the motor to the fully closed position on the track and clamp on (please see Installation Instructions for more details on how to do this).
2. Press and hold both Side Switch **L** and Side Switch **R**.
3. After 3 seconds, the motor will jog indicating it has entered limit setting mode.
4. Using either Side Switch **L** or Side Switch **R**, tap the one that is facing the fully open position.
5. The motor will run towards the fully open position until it detects that it has reached the end.
6. Limit setting is now complete.

Normal operation

Pressing either side switch **L** or side switch **R** will send the motor in the same direction as the direction of the push. The motor will continue running until either a) it reaches the end limit or b) the opposing side switch is pressed.

Troubleshooting

Motor is not responding

1. Ensure the motor is not in Deep Sleep Mode.
2. Ensure motor has been paired to the desired channel on the remote control.
3. Ensure the correct channel has been selected on the remote control.
4. Try recharging the battery.
5. Try setting the limits again.

Motor is running slowly

Try recharging the battery.

15 CHANNEL REMOTE LUNA GLIDE INSTRUCTIONS

Motor is moving in increments

1. Ensure the motor limits have been set.
2. Ensure motor is not in **CONFIG** mode.
3. Try recharging the battery.

Motor limits are shifting over time

1. Ensure the correct order is followed when setting limits (i.e. always start with fully closed limit).
2. Ensure the track surface is dry and completely clean from any lubricant residue or debris.

Luna Glide Centre Opening

Prepare Two Luna Glides

Ensure you have two Luna Glides.

Set Up First Motor

Set up your first motor following all the instructions above.

Turn Off First Luna Glide

Turn off your first Luna Glide by holding down the program button until the status button flashes red.

Pair Second Motor

Grab your second motor and pair it exactly the same way as the first motor.

Match Channel for Both Motors

When pairing the second motor, ensure it is paired to the same channel as the first motor.

Reverse the Motors

For a 15-channel remote: Hold down **P1** + **P3**,  + , and .

Re-Turn On First Motor

Turn on your first motor. Your Luna Glide centre opening should now be fully paired

15 CHANNEL REMOTE LUNA GLIDE INSTRUCTIONS

Using the Smart Control Module (SCM)

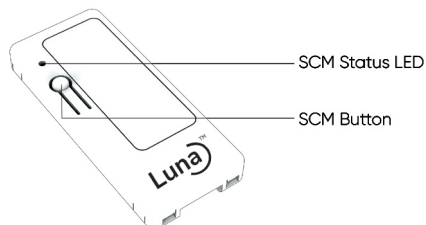

Installation

1. Using a flathead screwdriver, remove the SCM compartment cover as shown.

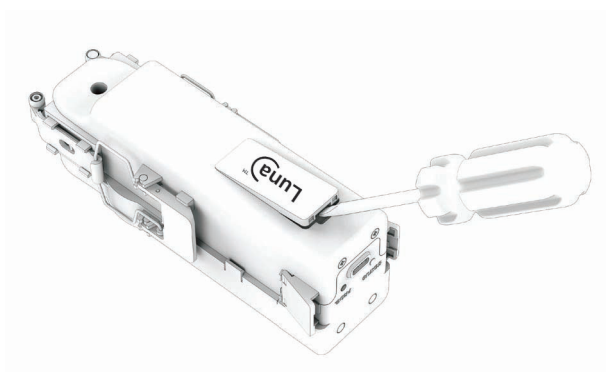

2. Insert the SCM into the compartment top first, then snap the bottom into place.

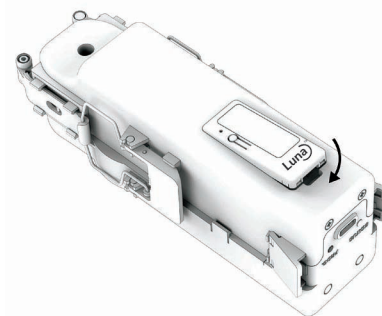

Network Commissioning

1. Ensure motor is not in Deep Sleep Mode.
2. Press the SCM button once. The SCM Status **LED** will start a blink sequence with 4 quick green blinks followed by a short pause.
3. At this time, complete the commissioning process by following the on-screen instructions of the desired smarthome ecosystem provider.

Note:

If the motor was in Deep Sleep Mode when the SCM is first installed, please wake the motor up, then initialise the SCM by pressing the SCM button once. The SCM Status **LED** will blink green once to indicate successful initialisation.

15 CHANNEL REMOTE LUNA GLIDE INSTRUCTIONS

SCM Factory Reset

1. Press and hold the SCM button until the SCM Status **LED** lights up as solid amber.
2. Release the SCM button.

Note:

If the SCM has been previously commissioned to a network, a factory reset is required before it can be commissioned once more.

Deep Sleep Mode

The motor has a deep sleep mode to minimise battery consumption and prevent accidental activation during transportation or storage. Motors are always shipped with deep sleep mode activated.

Wake up from deep sleep mode

When motor is in deep sleep mode, hold down the **PROG** button until the status **LED** blinks green 3 times. Motor is now in active mode.



Enter deep sleep mode

When motor is in active mode, hold down the **PROG** button until the status **LED** blinks amber 3 times. Motor is now in deep sleep mode.



To clear limits:

1. Hold **P2 + P3** until motor jogs
2. Hold **P2 + P1** until motor jogs
3. Hold **P2 + P3** until motor jogs

To delete current channel:

1. Hold **P1 + P3** until motor jogs
2. Hold  +  until motor jogs

To delete all channels:

1. Hold **P1 + P3** until motor jogs
2. Hold  +  until motor jogs